

LAMECO

LAMINATED PRODUCTS



- Founded 2000
- Turnover 9 M€ (2007)
- Capacity 50 000m³ of glued timber = logs for 1000 houses
- The biggest laminated log producer in the world



LAMECO

LAMINATED PRODUCTS



LamecoWall®

Timber Panels

LamecoWall® is a new Lameco quality glued panel for exterior sheathing or interior decoration. The new LamecoWall® is a perfect solution for both timber and prefabricated houses.

The untreated LamecoWall® wall is easy to finish with the desired method, for instance by painting, waxing, lacquering, staining or oiling.



LamecoWall Timber Panels 19 x 208
LamecoWall Timber Panels 28 x 208
LamecoWall Timber Panels 28 x 260

LAMECO
LAMINATED PRODUCTS

Lameco LHT Oy
Hirsitie 1, 73200 Varpaisjärvi
tel. +358 17 775 270
fax +358 17 775 271
www.lamecolht.fi



LamecoThermoFloor®

Thermal Wood Floorboards

LamecoThermoFloor® is a new glued thermal wood floorboard that feels comfortable under your feet.

The new LamecoThermoFloor® is a superior solution for wooden floors. The wide, glued floorboard is quick and easy to install.

The untreated LamecoThermoFloor® floor is easy to finish with the desired method, for instance by painting, waxing, lacquering, staining or oiling.



The product is 100 % disposable by burning as it contains no harmful substances.

LamecoThermoFloor 28 x 229

LAMECO
LAMINATED PRODUCTS

Lameco LHT Oy
Hirsitie 1, 73200 Varpaisjärvi
tel. +358 17 775 270
fax +358 17 775 271
www.lamecolht.fi



LamecoPost®

Duo- ja Trio Glulam Columns

LamecoPost® Duo and Trio are durable glulam columns. LamecoPost® Duo and Trio are dimensionally precise solutions for all locations that require unbendable, durable and supporting structure material, which has excellent glulam properties.

LamecoPost® Duo and Trio are glulam columns that are easy to process with regular tools.

LamecoPost Duo measurements:

90 x 90
134 x 134

LamecoPost Trio measurements:

190 x 190
165 x 165

LamecoPostDuo®
glulam column

LamecoPostTrio®
glulam column

LAMECO
LAMINATED PRODUCTS

Lameco LHT Oy
Hirsitie 1, 73200 Varpaisjärvi
tel. +358 17 775 270
fax +358 17 775 271
www.lamecolht.fi

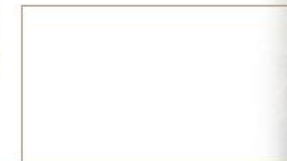

LamecoThermoLog®

Thermal Timber



25 % better thermal isolation.
The solution for energy efficiency in timber buildings.

Ecological and durable.
Certified decay resistance combined with the performance of resin-free and ecological Lunawood® thermal wood.

Gluing solution for thermal wood
The result of Lameco's continuous and successful product development.

Dimensional stability
Improved timber dimensional stability stands for decreased indentation and better wall sealing.



134x230(218)



180x230(221)/6



230x280(271)/6

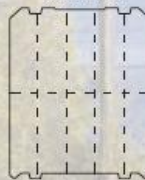

From the beginning of 2010 LamecoThermoLog® will respond to tightening building regulations. LamecoThermoLog® offers an entirely new and ecological solution that is a result of years of demanding product development. Take a step towards future building already today and get to know the most ecological building product family on the market.

LAMECO
LAMINATED PRODUCTS

Lameco LHT Oy
Hirsitie 1, 73200 Varpaisjärvi
tel. +358 17 775 270
fax +358 17 775 271
www.lamecolht.fi



LamecoAirLock®

Lamella Timber



Lameco's patented corner type

New building regulations require buildings to have a thick structure with a good thermal conductance coefficient and air tightness. The patented and tested LamecoAirLock® corner solution guarantees 50 % better sealed timber corners.

Contact our factory for more information.

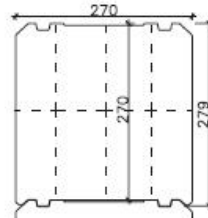

LAMECO
LAMINATED PRODUCTS

Lameco LHT Oy
Hirsitie 1, 73200 Varpaisjärvi
tel. +358 17 775 270
fax +358 17 775 271
www.lamecolht.fi



LamecoFrame®

Glulam Frame Pillar



LamecoFrame® is a new type of glued frame pillar. LamecoFrame® is an ideal and dimensionally precise solution for all locations that require unbendable, durable and light supporting structure material, which has excellent glulam properties.

LamecoFrame® frame pillars are also easy to work with regular tools.

LamecoFrame glulam frame pillar sizes:

- 48 x 44
- 48 x 66
- 48 x 88
- 30, 39, 48, 70 x 175
- 30, 39, 48, 70 x 198
- 30, 39, 48, 70 x 220
- 30, 39, 48, 70 x 240
- 30, 39, 48, 70 x 310
- 30, 39, 48, 70 x 350
- 30, 39, 48, 70 x 400
- 30, 39, 48, 70 x 440

Lameco's LamecoFrame® rafters can be used for all building, for example in interior and exterior wall frame pillars, joists and rafters.

Lameco's LamecoFrame® is a premium construction material that is the result of extensive product development.

LAMECO
LAMINATED PRODUCTS

Lameco LHT Oy
Hirsitie 1, 73200 Varpaisjärvi
tel. +358 17 775 270
fax +358 17 775 271
www.lamecolht.fi





THE HIGH END OF
LOG
HOMES

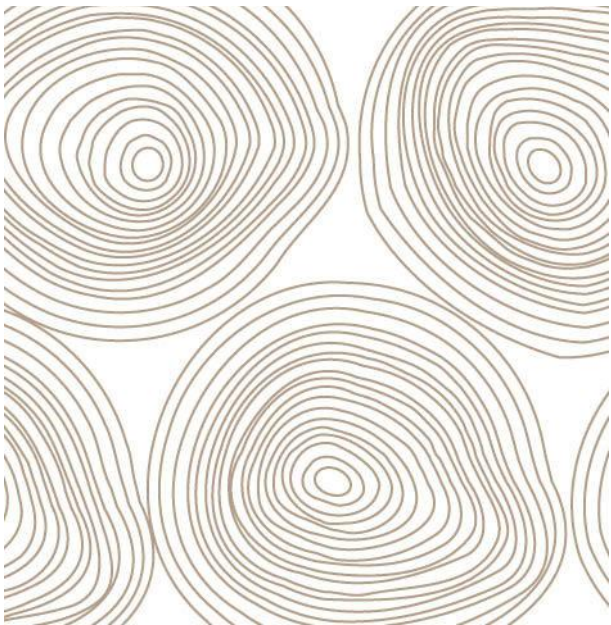

RANTASALMI

The oldest log house manufacturer in Finland

- Established 1946
- From sawing and bed manufacture to log sauna producer
- Break-through as sauna producer: Rantasalmi got 28 orders in 1956 in Helsinki
- **This was the beginning of industrial log production in Finland**
- **Take over by Lameco 2010**



THE HIGH END OF
LOG
HOMES

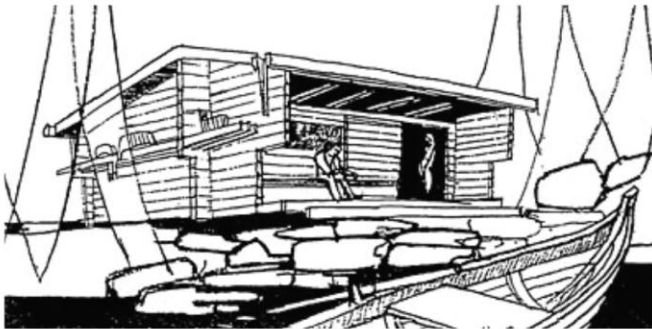

The beginning of the finnish log house export

- 1958 Reima Pietilä designed a sauna to Finland's stand in World Fair in Brussels
- **This was the beginning of log house exportation from Finland.**
- Rantasalmi was pioneer in exporting to Japan and Germany already in the 1970's



THE HIGH END OF
LOG
HOMES



Production facilities

- Five production lines
- Capacity 500 houses
- Site 16 hectares
- Production, office and storage space all together 15 000 m²



THE HIGH END OF
LOG
HOMES



 RANTASALMI

Strong in export and homeland



- Turnover ab. 10 million € (2012)
- 10 domestic representatives
- Exportation over 50 % of production
- Exportation to 15 different countries
- The most important countries are German, Japan, France, Russia



THE HIGH END OF
LOG
HOMES



For living and leisure time

- Products
- Houses, Vacation houses, Indoorsaunas
- Projects
- Laminated logs
- Processed timberproducts (glued panels)



THE HIGH END OF
LOG
HOMES



 RANTASALMI

Log assortment



- Laminated logs



- Processed timberproducts



THE HIGH END OF
LOG
HOMES

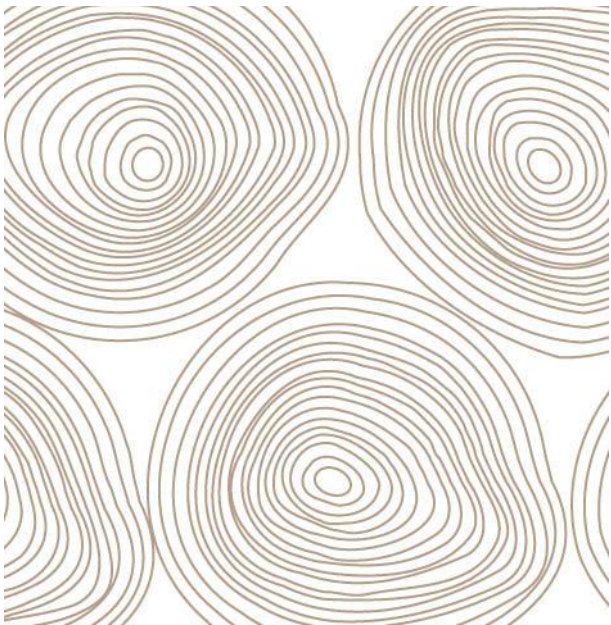

 RANTASALMI

Log assortment

Pienet hirret / Small laminated logs

88x192(180) 113x192(180) 134x192(180)

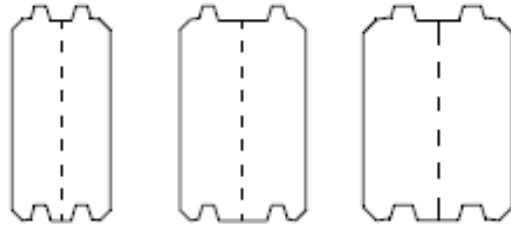

Lamellihirret / Laminated logs

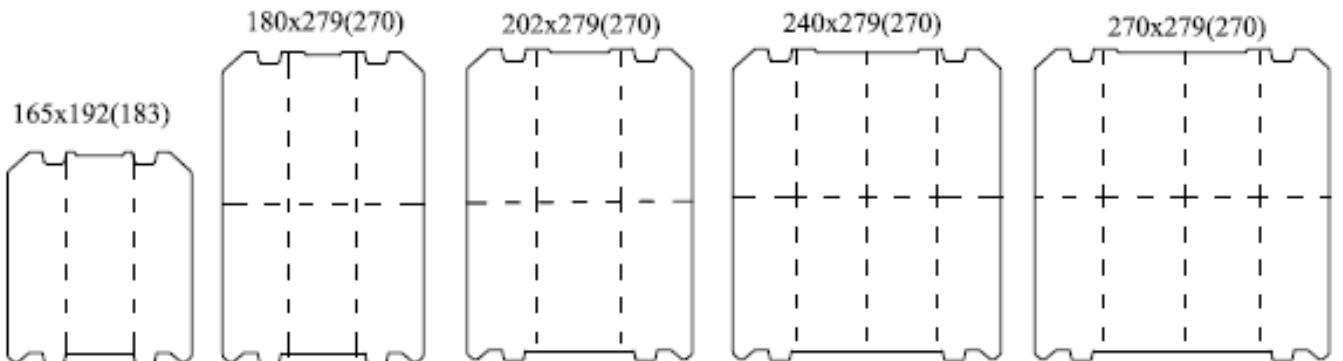

Pyöreät lamellihirret / Round laminated logs

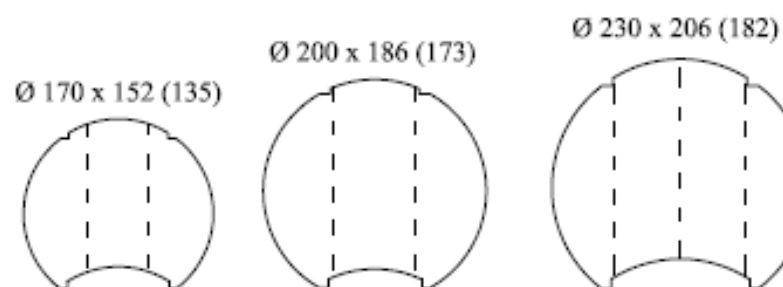

D-hirsi / D-profil

D 138 x 192 (180)

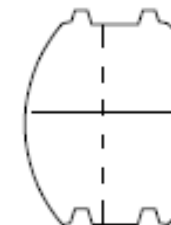



RANTASALMI



THE HIGH END OF

**LOG
HOMES**



RANTASALMI



THE HIGH END OF

**LOG
HOMES**



RANTASALMI



THE HIGH END OF

LOG
HOMES



RANTASALMI



THE HIGH END OF

LOG
HOMES



 RANTASALMI



THE HIGH END OF
LOG
HOMES



 RANTASALMI



THE HIGH END OF
LOG
HOMES



RANTASALMI



THE HIGH END OF
LOG
HOMES



RANTASALMI



THE HIGH END OF

LOG
HOMES



 RANTASALMI



THE HIGH END OF
LOG
HOMES

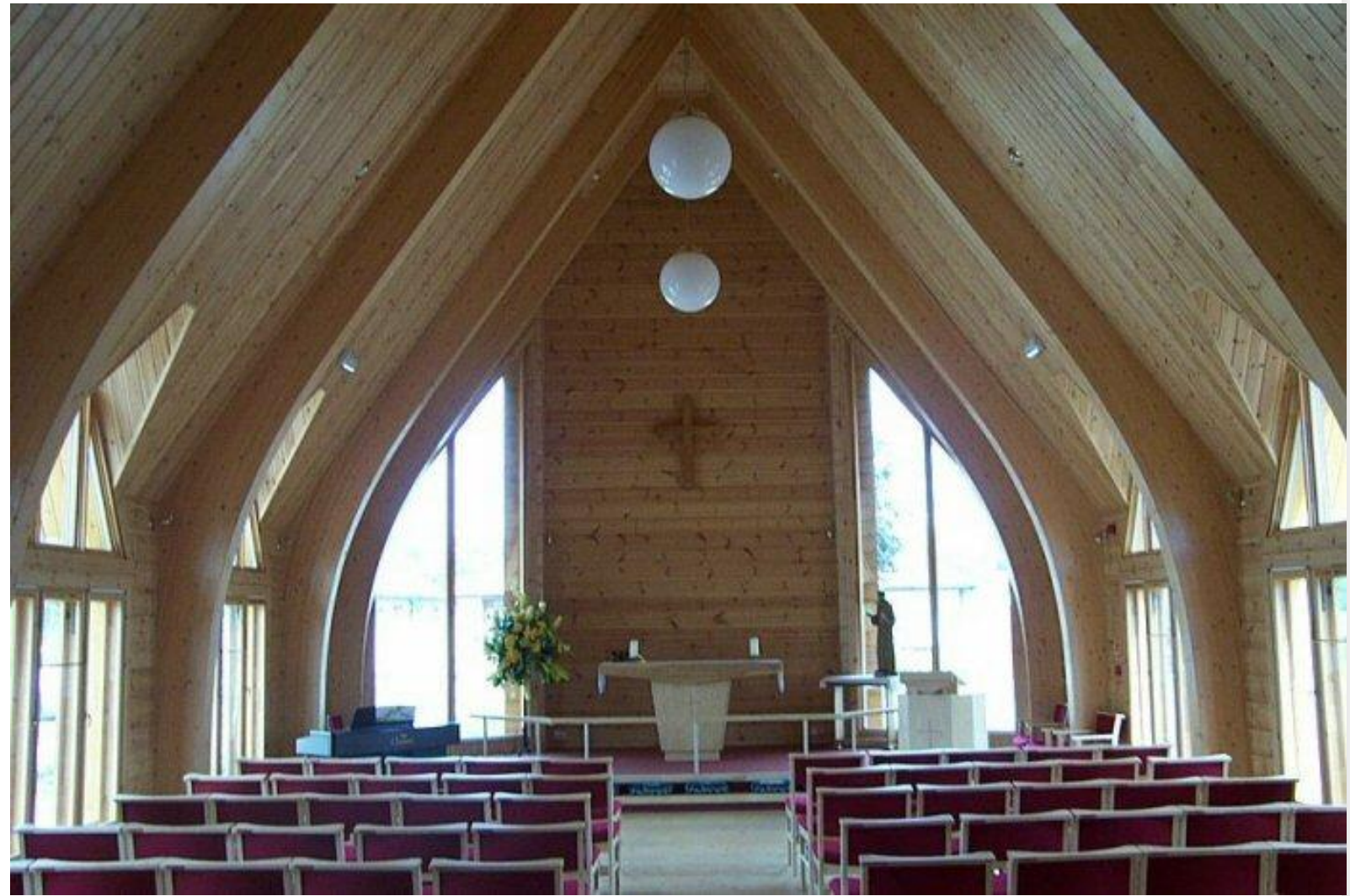

THE HIGH END OF
LOG
HOMES



 RANTASALMI



THE HIGH END OF
LOG
HOMES



RANTASALMI



THE HIGH END OF
LOG
HOMES



 RANTASALMI



THE HIGH END OF
LOG
HOMES



RANTASALMI



THE HIGH END OF

LOG
HOMES



THE HIGH END OF
LOG
HOMES



 RANTASALMI



THE HIGH END OF
LOG
HOMES



RANTASALMI



THE HIGH END OF

LOG
HOMES



 RANTASALMI



THE HIGH END OF
LOG
HOMES



 RANTASALMI



THE HIGH END OF
LOG
HOMES



 RANTASALMI



THE HIGH END OF
LOG
HOMES



 RANTASALMI



THE HIGH END OF
LOG
HOMES



RANTASALMI



THE HIGH END OF

LOG
HOMES



THE HIGH END OF
LOG
HOMES

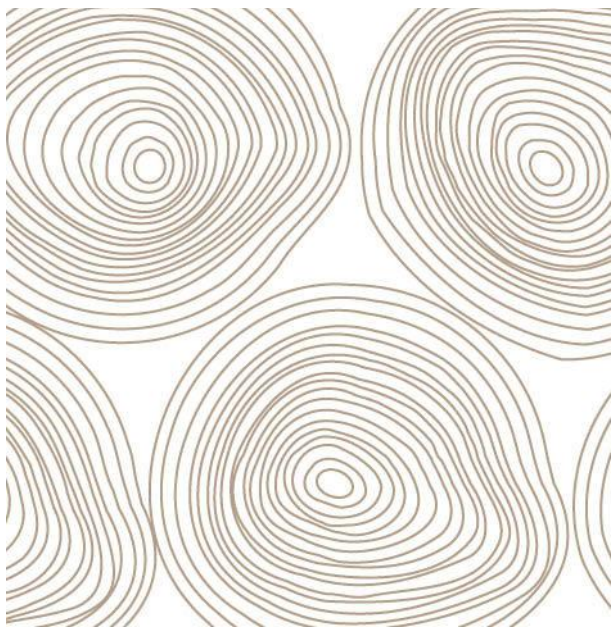

 RANTASALMI

Master plan projects`examples

Architect - Asko Lax



Rantasalmi log houses offers also master plan design. We have experience of many projects globally. When producer of houses is choosed enough early and project is planned together . This way we have better idea from the project and this helps us to plan houses according to goal.

- Cheaper to buy
- Quicker to build

THE HIGH END OF
LOG
HOMES

Master plan examples

Project Sofia, Bulgaria
Architect - Asko Lax

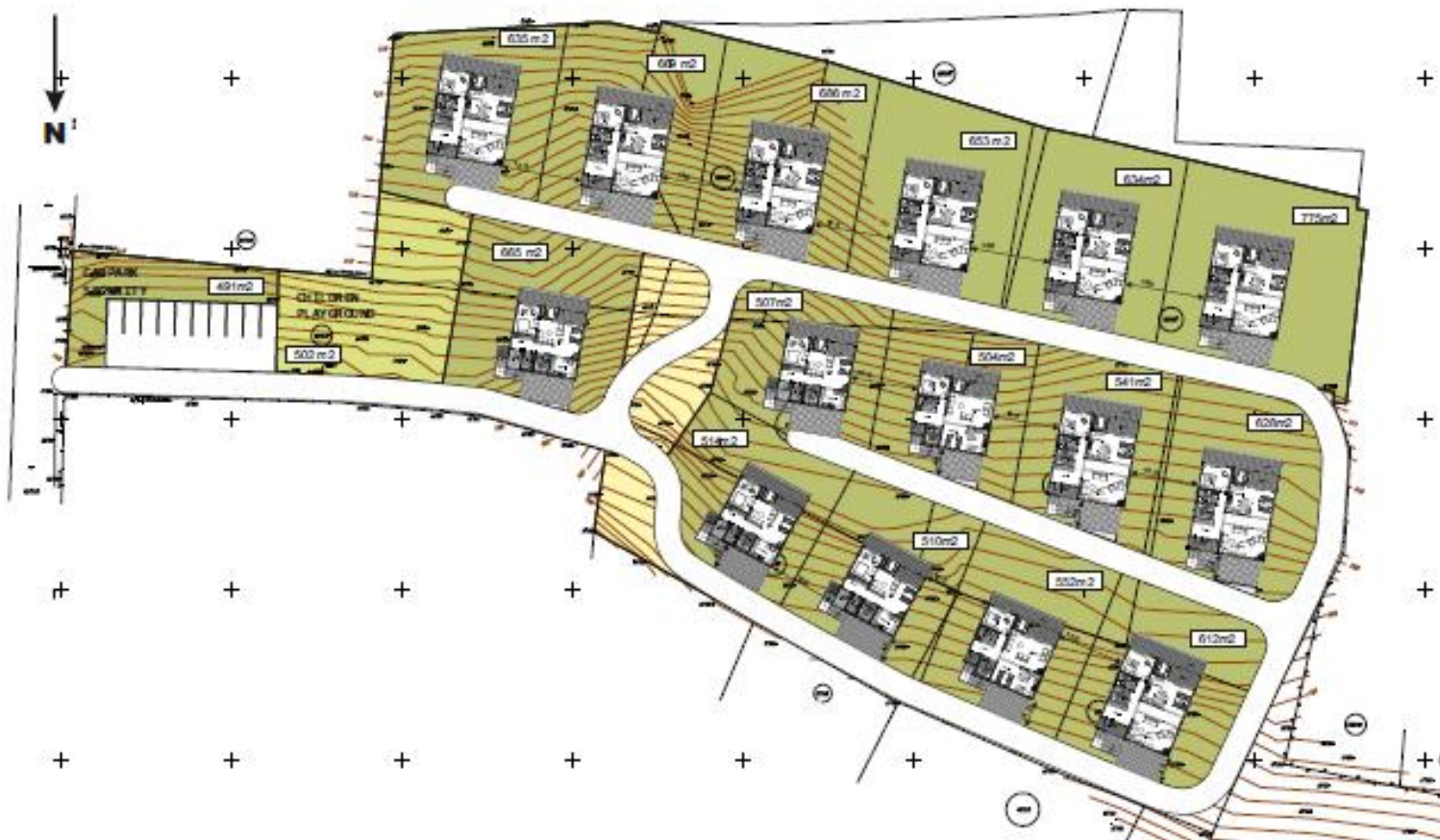



THE HIGH END OF
LOG
HOMES



Project Landysh, S-Peterburg. Architect - Asko Lax

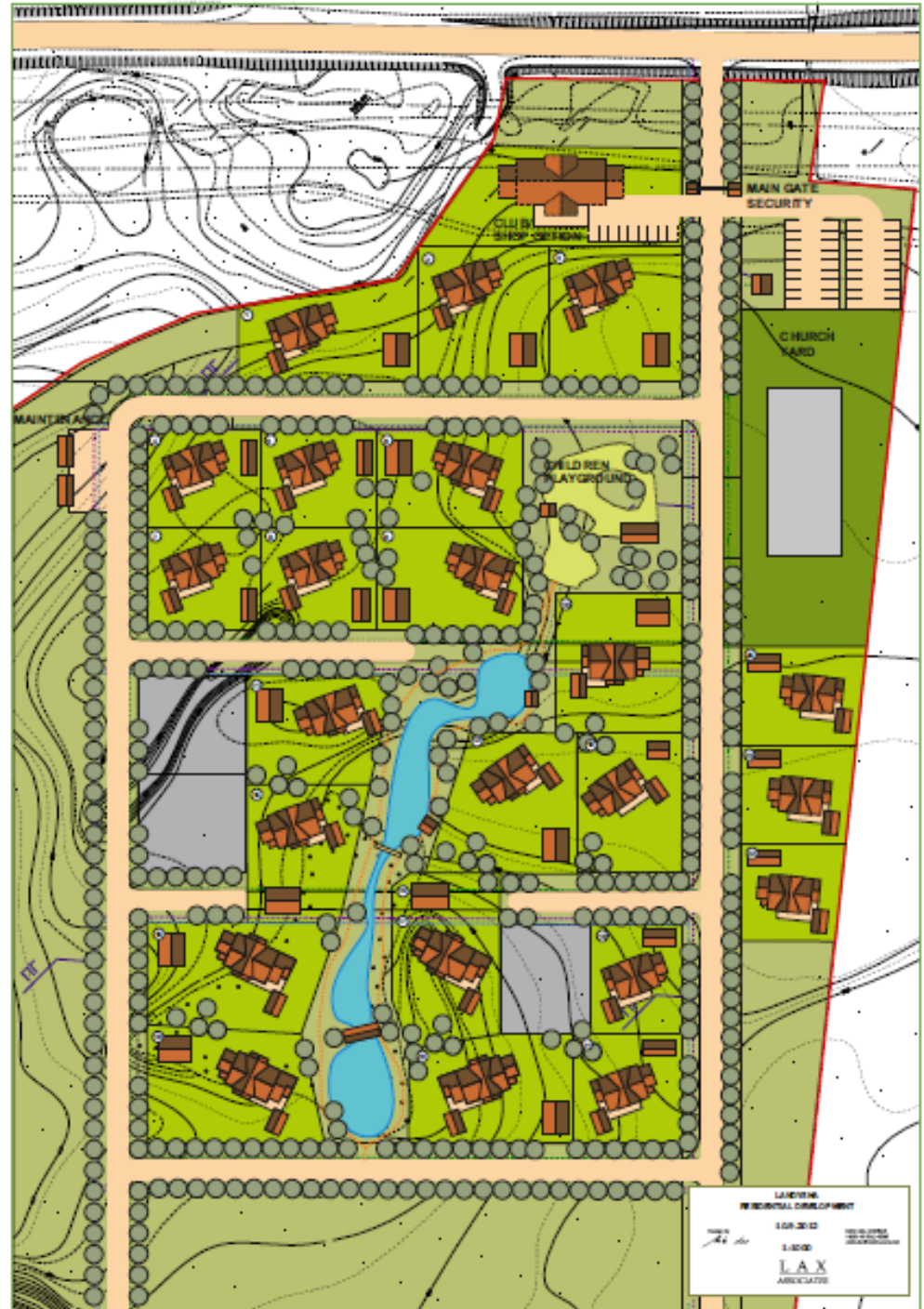



THE HIGH END OF LOG HOMES



Project Landysh, S-Peterburg. Architect - Asko Lax

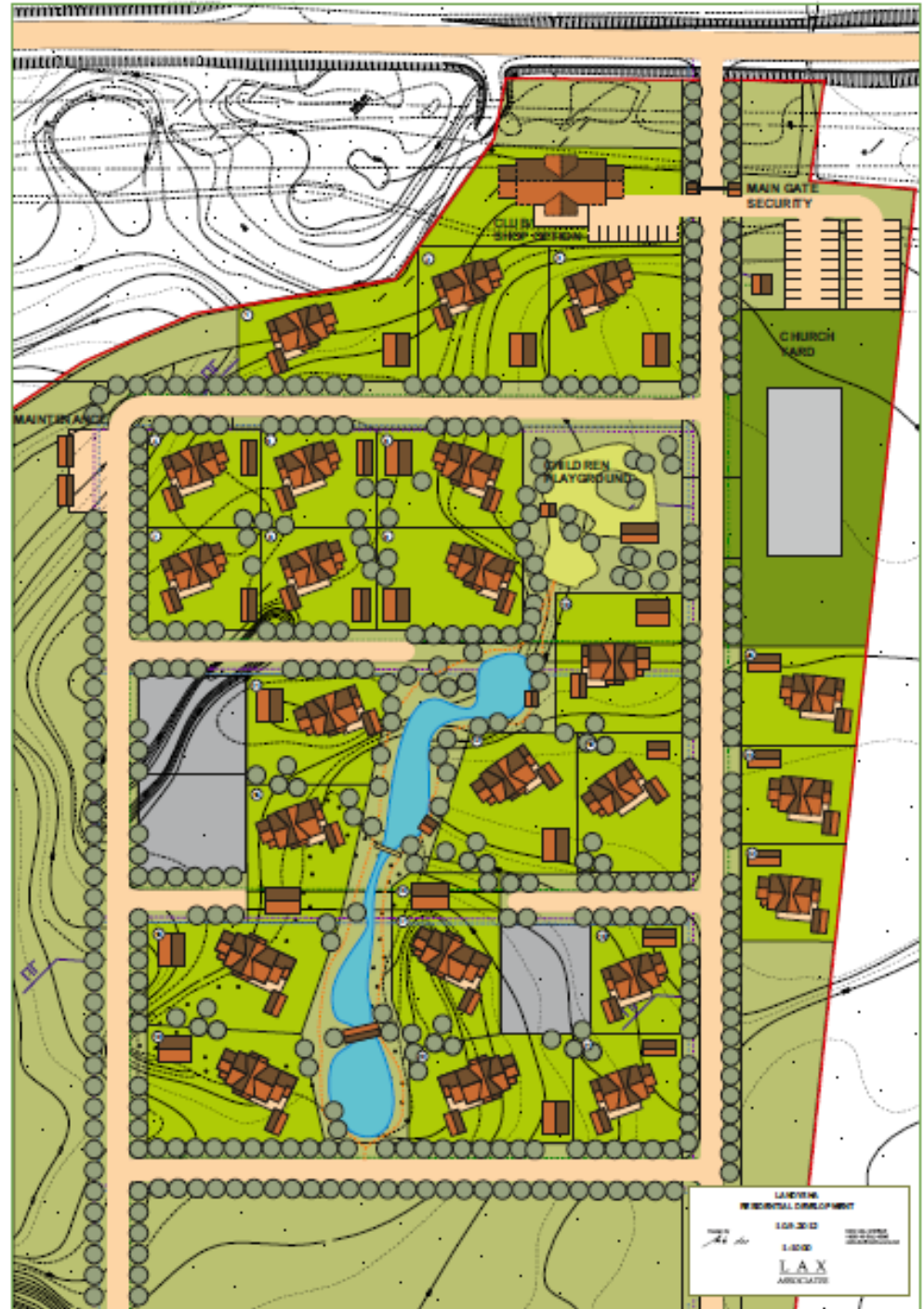

Thank you for your attention!

